

Smart Camera Pal

Sony Version

Dedicated section for Sony cameras.

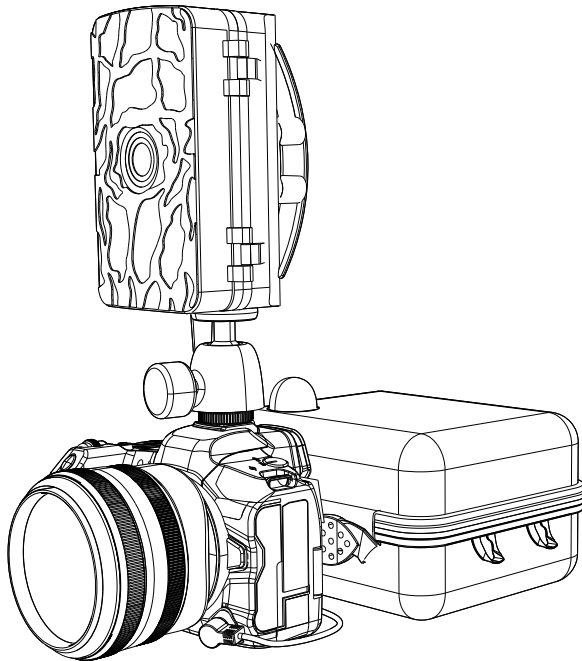

Content

Chapter 1 The setting of Sony digital camera

1. Compatible models of Sony camera.....	1
2. Instructions and illustrations diagram of Sony model data cable.....	1
3. Battery converter list of Sony main models.....	1
4. Setting requirements of digital camera.....	1
5. Button setting of digital camera video recording.....	2
6. Power saving settings and wake-up time after standby of digital camera.....	2
7. Standby time and continuous shooting time of digital camera.....	4
8. Focus setting of digital camera lens.....	4
9. Memory card requirements.....	5

Chapter 2 Shooting function and use requirements of the Smart camera pal 6

Chapter 3 Shooting function settings of the Smart camera pal 7

1. Connection method of the touch screen display [Pai Ppi bao].....	8
2. The touch screen display interface introduction.....	8
3. How to use the touch screen display.....	8

Chapter 1 The Setting of Sony digital camera

1. Sony camera compatibility

A1, A7SIII, A7RIV, A7RIII, A9, A9II, A7MIV, A7MIII, FX30

2. Instructions and illustrations diagram of Sony model data cable

Model	Shutter release cable
A1, A7SIII, A7RIV A9, A9II, A7MIV, FX30	S2  3.5mm

3. Battery converter list of Sony main model

Camera Model	Battery converter model
A1, A7SIII, A7RIV, A7RIII A9, A9II, A7MIV, A7MIII, FX30	U/BC-Z100

Using the camera's own battery may not ensure long-term power supply.
Using the Smart camera pal power supply can meet the endurance requirements.
The camera battery converter standard with one.

Note: When installing the battery converter on a Sony camera, you need to remove the digital camera battery compartment cover, and please keep it safe.

4. Setting the purpose of saving static images.

Here we take the A1 as an example.



5. Button setting of camera video recording

To switch from the video button mode to the shutter button mode for video recording. Here we take the A1 as an example.

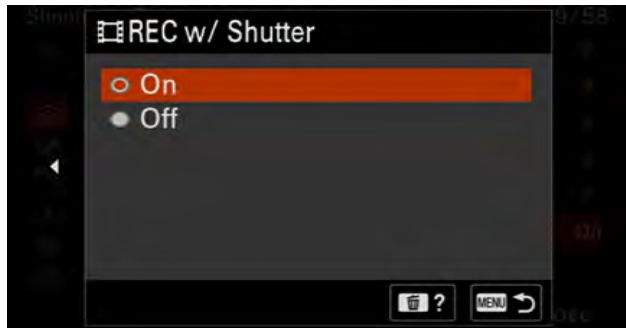
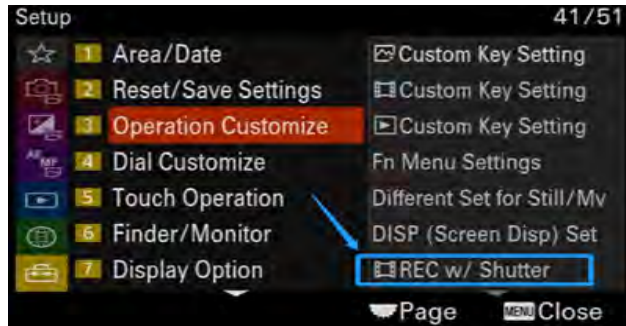

6. Power saving settings and wake-up time after standby of digital camera

(1) The camera can be set to either turn off or do not turn on the auto-hibernation mode.

- a. The above two settings have a significant impact on the camera's power consumption, which directly affects the outdoor usage time of the Smart camera pal.
- b. The above two settings have different response times for the Smart camera pal to control the digital camera to start shooting after being triggered by the trail camera. When the camera is in hibernation mode, it takes some time for the Smart camera pal to wake up the camera and enter shooting mode.

Camera status	Wake-up time for mirrorless cameras	
	Shooting mode	Recording mode
Hibernation status	2s	2s
Dis-hibernation status	0	0

The user can decide whether to turn off or keep the sleep mode function of the camera according to the shooting situation.

(2) Setting method for mirrorless camera using A1 as an example

a. In the menu, set "Auto power off" to "Off" so that the camera will not enter hibernation mode. Choosing other times will cause the camera to enter hibernation mode.

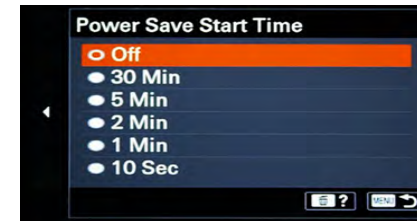
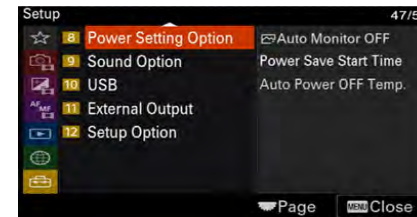

Among the Sony adapter models, only the A1 camera has the function to turn off hibernation mode. Other models cannot be set to turn off hibernation mode.

b. Also, turning off the display and viewfinder will reduce power consumption of the camera. After finishing the adjustment of the digital camera settings, please close the LCD screen to turn off the display.

7. Standby time and continuous shooting time of digital camera

The duration of outdoor shooting with the Smart camera pal directly affects the user's ability to capture the desired targets. The power consumption differs greatly between setting the digital camera to auto-hibernation or off- hibernation, as well as setting the LCD display to auto-off or not (always display the shooting screen).

The following table shows the calculation of camera standby time and continuous shooting time based on power consumption.

Camera Status		Camera Model	Mirrorless camera A1
		Battery Model	UB-04 82.88Wh
		Time Unit	Hour(s)
Hibernation Status	Camera body automatically hibernate		180
Video Mode	Countinuous recording (HD)		13

Notes:

- (1) The standby time of the digital camera is consistent with the usage time of the Smart camera pal.
- (2) Taking a representative models as examples, tested under indoor conditions and at a room temperature of 25 C , the data may vary depending on different usage environments and conditions.
- (3) The power consumption of different camera models varies slightly. Generally, higher-end models tend to consume more power.
- (4) There is a light sensing system, according to 12 hours a day to calculate the standby days.

8. Focus setting of Digital Camera lens

The digital camera lens set to AF autofocus mode and MF manual focus mode, there may be slight differences in response speed.

Camera Type	Model	Autofocus Setting for Lens	
		AF	MF
Mirrorless Camera	A1/A7SIII/A7RIV/A7RIII/A9II/A9 A7MIV/A7MIII/FX30	Yes	Yes

Notes: Most camera lenses have an AF/MF switch lever. Many newly released lenses do not have an AF and MF switch lever, and the lens focus mode can be set in the camera body menu.

The setting method takes A1 as an example

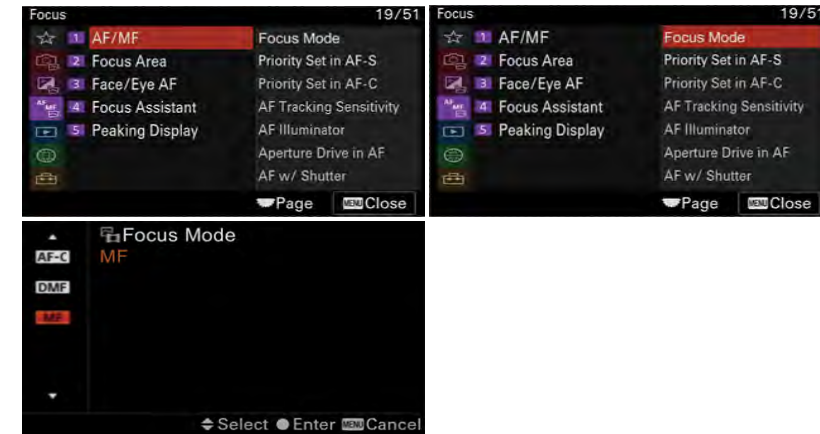

9. Memory card requirements

1. In shooting mode, the number of continuous shots will be affected during continuous shooting of the writing speed of the memory card is relatively low.You can continue to shoot until the camera has written all the pre-stored shots to the memory card.
2. In video recording mode, It will affect that the camera cannot shoot video normally according to the shooting function if the writing speed of the memory card is relatively low.A memory card with an appropriate writing speed is required.
3. Cameras that released too early are recommended to be used only for taking photos, not for videos. You must use a memory card with a fast writing speed for video recording.
4. The video cannot be taken due to the memory card, which results in that when the trail camera detects animals, the Smart camera pal cannot command the camera to start video recording.

- (1). For cameras with high pixels, the memory card cannot meet the shooting requirements when the video file has high pixels.
- (2). When the SD card inserted into slot 2, most cameras have specific file format and bitrate (Mbps) requirements. If the bitrate (Mbps) exceeds the specified requirements, it may result in the inability to capture video. For detailed information, please refer to the user manual of the camera model you are using.

Chapter 2. Shooting function settings for the standard version of the Smart camera pal

1. The Smart camera pal uses a fixed shooting function.

The Smart camera pal writes the shooting logic into the control system and cannot be adjusted. Using a dial switch, the switch is set to single shooting, continuous shooting, or video recording, and execute the corresponding shooting logic.

(1). At single shooting, the digital camera shooting mode must be set to single shot. Number of continuous single shots: 5

Continuous shooting interval time: 1 s

(2). At continuous shooting, the camera shooting mode must be set to continuous shooting, and the type of continuous shooting is not limited.

Every continuous shooting time: 2 s

Continuous shooting interval time: 1 s

Continuous shooting times: 3 time(s)

(3). At video recording, the camera shooting mode must be set to video recording.

Every recording time: 28 s

Interval time between sessions: 1 s

Recording times: 1 time(s)

When the Smart camera pal sold, the dial switch is set to the video shooting mode.

With an external shooting logic setting box [Pai pai bao], the shooting logic can be set or modified when using the Smart camera pal. Please refer to Chapter 3 for details.

2. Requirements for turning off the hibernation mode of the camera when using the Smart camera pal.

The use of the Smart camera pal without the [Pai pai bao], have the following requirements:

(1) Setting the digital camera lens to AF/MF focusing mode, as outlined in Chapter 1, Article 8.

(2) The digital camera's power-saving settings should be used as required to ensure effective shooting.

See the table below for details

Camera Power Saving Settings and Lens Focusing Settings					Mirrorless Camera Models
The camera will not enter sleep mode when the auto-hibernation mode is turned off.	Shooting mode	Single shooting	AF mode	Compatible models	All compatible camera models
			MF mode	Compatible models	
		Continuous shooting	AF mode	Compatible models	
			MF mode	Compatible models	
	Recording mode		AF mode	Compatible models	
			MF mode	Compatible models	
The camera will automatically enter sleep mode and power off when set to auto-hibernation mode.	Shooting mode	Single shooting	AF mode	Compatible models	All compatible camera models**
			MF mode	Compatible models	
		Continuous shooting	AF mode	Compatible models	
			MF mode	Compatible models	
	Recording mode		AF mode	Compatible models	
			MF mode	Compatible models	

Notes: **, When Sony cameras enter hibernation mode, the number of single shooting is reduced by 1-2 shots, the actual shots are 3-4. In continuous shooting mode, the number of shots for the first continuous shooting will be reduced.

This table also includes the AF/MF focus mode settings, so user can have a clear understanding of the usage requirements.

Chapter 3 Shooting function settings of the Smart camera pal

New shooting functions can be set and modified with the Smart camera pal connected to the [Pai pai bao].

(1) The digital camera's power-saving setting can be set to either off- hibernation mode or hibernation mode to significantly extend standby time.

(2) The digital camera's power on/off time can be set by adjusting the new shooting function when connected to the [Pai pai bao].

1.The connection method [Pai pai bao]

It would work that insert the connection cable into the data interface of [Pai pai bao].

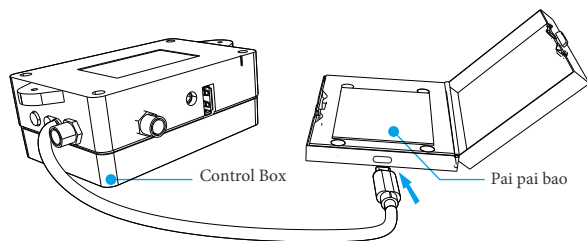

2. How to use Logic box

Logic box user manual

1. Upon initial connection to the Logic box, the display shows the default logic for a shooting modes(single shooting, continuous shooting, or video mode).
2. Logic box can only modify one shooting mode (single shooting, continuous shooting, video) at one time. Once the shooting mode is changed (by toggling the switch), any previously modified logic reverts to the default shooting logic.
3. Modified logic is retained in memory after adjustment. As long as the shooting mode remains unchanged, the modified logic remains effective. If the Logic box is removed or plugged in, the screen display returns to the default logic interface on the Logic box, but the modified logic remains active until new settings are applied.
4. The same principle applies to modifying interval times and shot count

Example: Modified logic set as 5 shots single shooting, 3s continuous shooting, and 35s video.

Control box mode		Default logic	After logic modification, the shooting mode remains unchanged (toggle switch unchanged)				After logic modification, as long as the shooting mode is changed (by toggling the switch), the logic reverts to the default shooting logic.
			The Logic box remains connected to the Smart camera box, and the Smart camera box remains powered on.		If the Logic box is removed or plugged in and the Smart camera box's power turned on or off.		
		Number of shots/ Video time	Logic box display	Actual shooting logic	Logic box display	Actual shooting logic	Logic box display/ Actual shooting logic
Shooting mode	Single shooting	3 shots	5 shots	5 shots	3 shots	5 shots	3 shots
	Continuous shooting	2s	3s	3s	2s	3s	2s
Video		28s	35s	35s	28s	35s	28s

3. Logic box Interface Introduction

Page 1: Cover - Smart camera pal Sony version

Page 2:

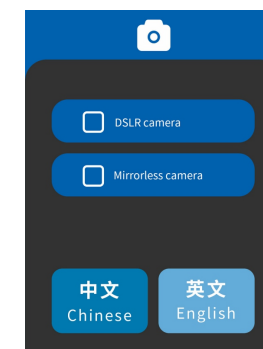
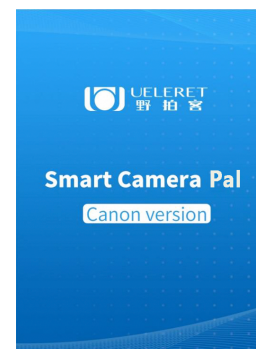

Enter the "Logic box" page, first select the type of camera: DSLR or mirrorless camera. Depending on whether the digital camera can go into hibernation mode or if the LCD screen turns off, the functions of shooting will differ for DSLRs and mirrorless cameras. Once selected, the Smart camera pal will provide corresponding shooting instructions to meet the digital camera's different settings. Failure to follow these instructions may result in disorderly shots or failed shooting attempts.

Page 3:

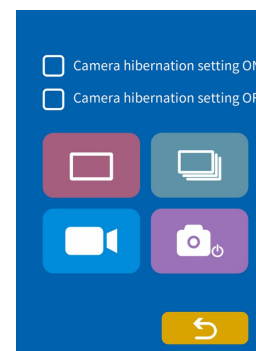

The option "Enable Camera Hibernation" refers to the digital camera being set to hibernate. When the shooting ends after a certain amount of time, the digital camera's power-saving function will put the digital camera into hibernation mode.

The option "Disable Camera Hibernate" refers to the digital camera turned off the power-saving function, and the digital camera will not enter hibernation mode.



Set your digital camera to single shooting mode and click to enter the shooting function settings page for single shooting mode.



Set your digital camera to continuous shooting mode and click to enter the shooting function settings page for continuous shooting mode.



Set your digital camera to recording mode and click to enter the shooting function settings page for recording mode.

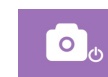

Click to enter the digital camera shutdown and startup time settings page.

Page 4: Shooting function settings for single shooting mode.

Click on the blue box to pop up the number selection options.

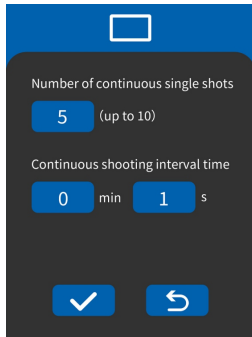

After confirming the settings, if the settings are successful, the OK page will pop up. If the settings are not successful, the NO page will pop up. The same process applies for subsequent pages.

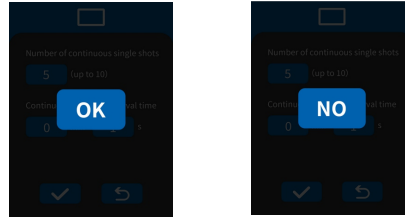

Page 5: Click on the blue box to enter the number selection options for shooting function settings for continuous shooting mode.

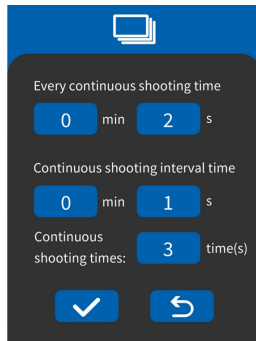

Page 6: Click on the blue box to enter the number selection options for shooting function settings for recording mode.

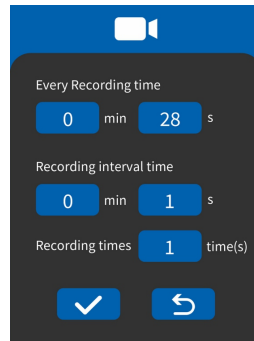

Page 7: Digital camera shutdown options

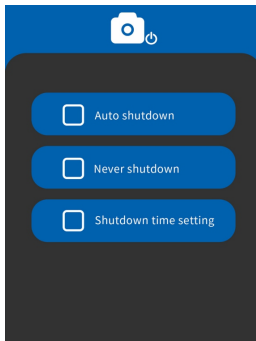

Note of Page 7

(1). Digital camera [Power Off] is different from [Hibernation]. Turning off the digital camera means that the Smart camera pal stops supplying power to the digital camera, and the digital camera stops working completely. The digital camera into hibernation mode means that the power saving function of the digital camera itself makes the digital camera enter the hibernation mode, while the Smart camera pal continues to supply power to the digital camera.

(2). Option "Auto shutdown"

When this option is selected, the Smart camera pal will automatically stop supplying power to the digital camera and put it into a shutdown state when day and night change, the light sensor detects that ambient light intensity is insufficient for the digital camera to take pictures. The Smart camera pal is in the lowest power consumption state in this mode. When the light intensity reaches the required level for photography, the Smart camera pal automatically supplies power to the digital camera, and the digital camera enters the power-on state.

(3). Option "Never shutdown"

When this option is selected, the Smart camera pal will continuously supply power to the digital camera, even if the light sensor detects that the ambient light intensity changes, the Smart camera pal will not issue an instruction to stop powering the digital camera, and the digital camera will be in continuous working mode.

This option is generally used when the user has connected a flash or lighting equipment, and the digital camera needs to take pictures at night.

(4). Option "Shutdown time setting"

If the user does not want to use the ambient light sensor to automatically turn off the digital camera based on the brightness of the surroundings, thinks that the shooting conditions require a customized power-off or power-on time, then can select this option, and enter the page 8 to manually set the power off time and duration.

Page 8: Enter the "Setting the shutdown time"

User can set how long will the digital camera take to shut down and the duration for which it will remain off. As there is no clock on the camera, it is not possible to set the power off time based on local time (such as Beijing time or London time). Instead, the power off time is set based on the working duration time.

Click on the blue box to pop up the number selection options. After confirming the settings, if the settings are successful, the OK page will pop up. If the settings are not successful, the NO page will pop up.

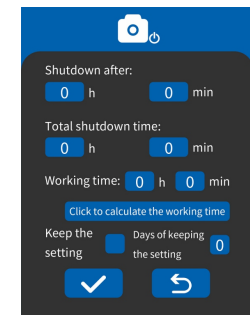

Disclaimer: As this product is an original patented product, there may be changes in its features or specifications in the future. In the event of any changes, please refer to the official website of our company. Yueguang Intelligent reserves the right to interpret any changes.